

Dilgard & Associates, 135 Union Street, Ashland, OH 44805 419-281-2122
Lots and Land - Information deemed reliable but not guaranteed

Status Active
 MLS Number **211775**
 Price **\$69,000.**

Location

Area Ashland Sch(Suburban)
 Street Number 0
 Street TR 1186
 Unit #
 City Ashland
 Township Milton
 County Ashland
 ZIP 44805
 State Oh

 School District Ashland City

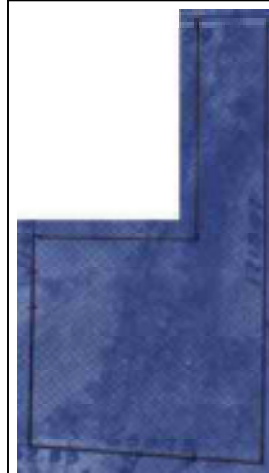

Lot Data

Acres 12.0000
 Lot Size 12 Acres +/-
 Frontage 200.0000
 2nd Frontage 0.0000
 Road TR 1186
 2nd Road
 Open No
 Wooded Yes
 Mineral Rights
 Land Features Creek, Wooded, Construction Lot,
 Tillable
 Flood Plain Unknown
 Zoning TWP
 Parcel # Part of G220011000403
 Legal Lot# Part of Section 1 LOT 4
 Utilities on Site None
 Utilities Available Well Avail, Cable Avail, Electric Avail,
 Phone Avail, Septic Avail

 1/2 Taxes \$0.
 Health Dept Appr No

Listing Data

Agent Name Hugh "Jim" Barr
 Agent Phone 419-945-2783
 Firm Name Dilgard & Assoc. Inc
 Firm Phone 419-281-2122
 Co Agent
 Owner Last Name Mettler
 Owner First Name Wayne

 Sub Agent/Co-op 0.0
 Buyer Broker 2.75
 Exclusive No
 Variable Rate No

 Docs on File
 Possession Transfer Title
 Survey Needs Survey

 Video/Phones No
 Internet Yes
 Option on Property No

Directions

ST RT 96 west to right on TR 1153 to right on TR 1186, on right

Remarks

Mostly wooded lot with stream, abundant wildlife, and great building site. Close to town but in the country! subject to final survey. Taxes to be determined.

Auctioneers & Realtors Since 1953

DILGARD
 REAL ESTATE • AUCTIONEERS

135 Union St. Ashland, OH 44805
 (419) 281-2122 Bus.
 (419) 289-2772 Fax
 (419) 945-2783 Res.
 (419) 651-2035 Cell
 jharr@earthlink.net E-mail

HUGH "JIM" BARR, GRI
 REALTOR/Sales Associate
 Auctioneer